

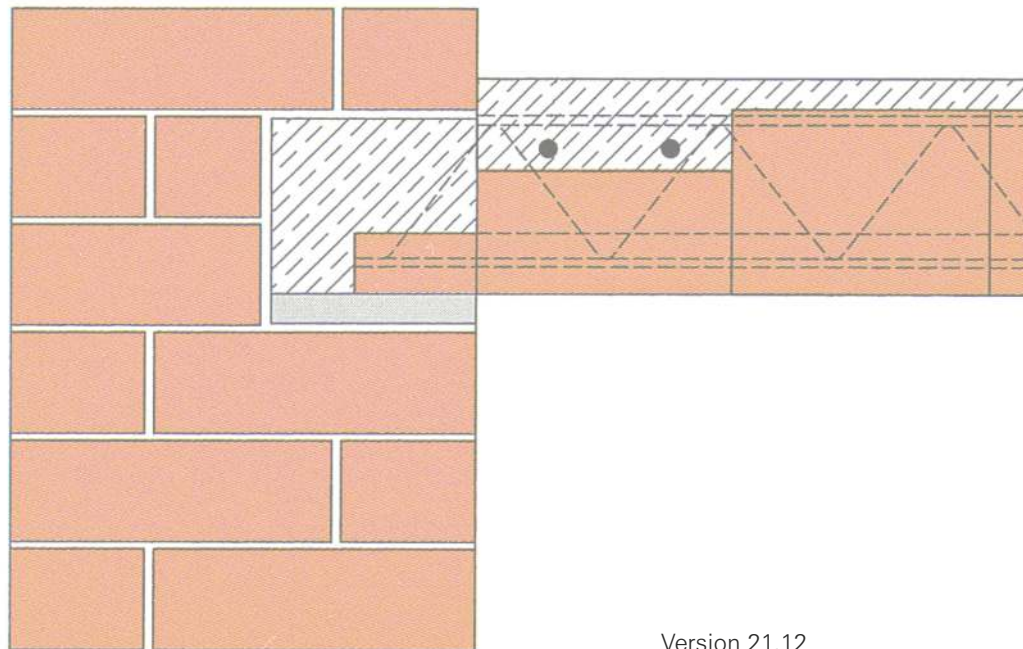

Detailzeichnungen für Ziegel-Einhängedecken System Fiedler





1 Auflager für Decken

... im Randbereich

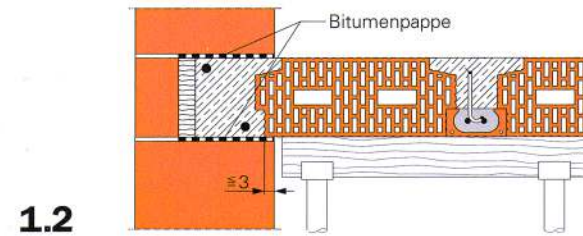
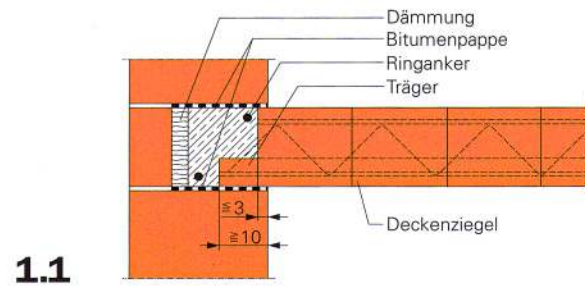

... über Wandöffnung

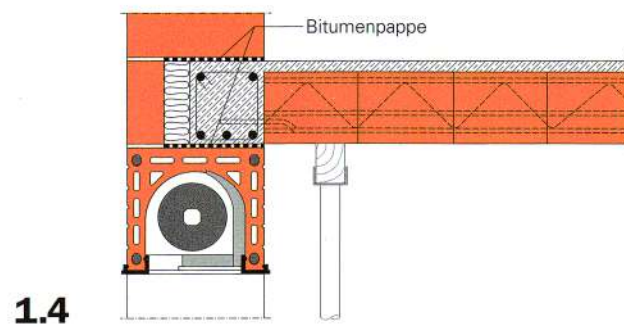



... im Sanierungsbereich

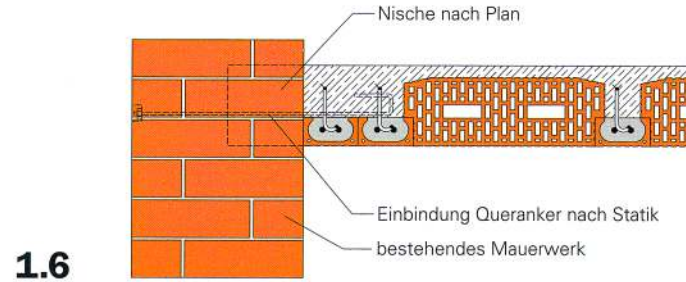
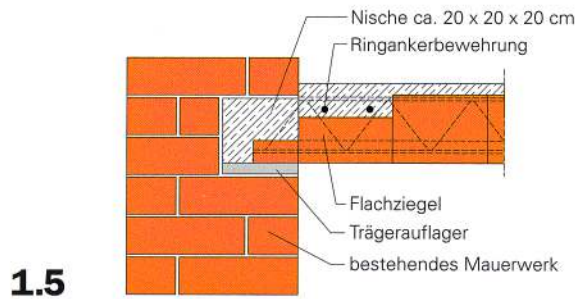

② Querrippe

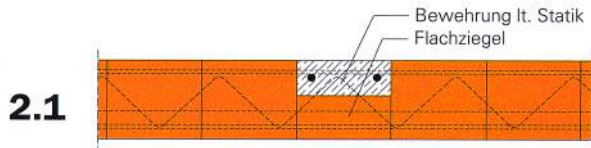

③ Auswechslung

... bei einem Deckenträger

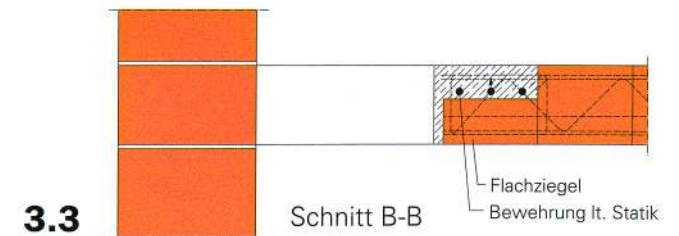
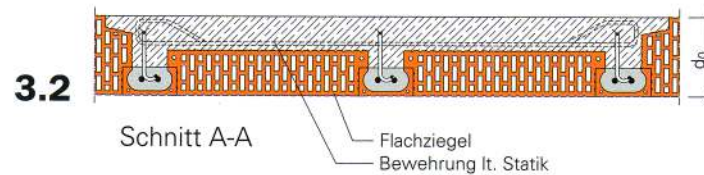
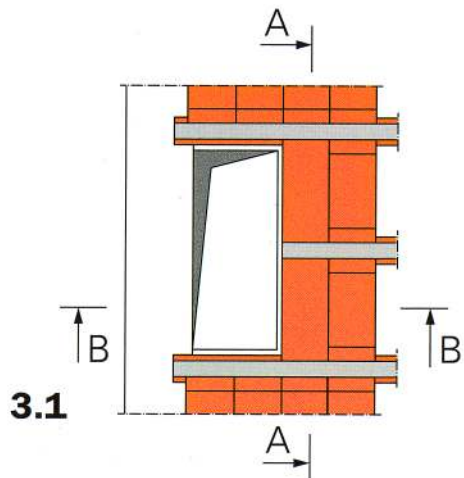



... bei zwei Deckenträgern (Wechselträger)

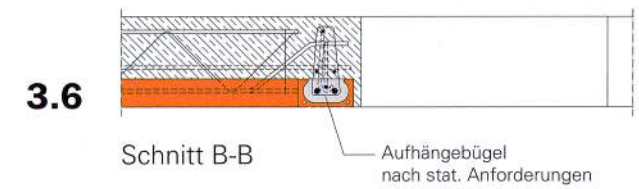
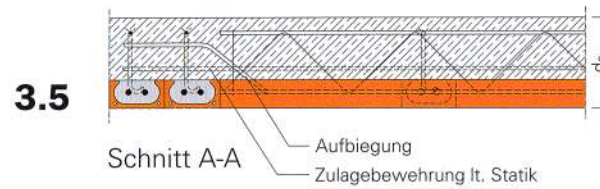
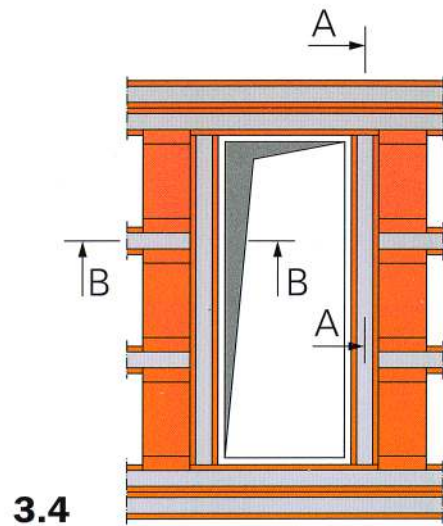

4 Abfangung

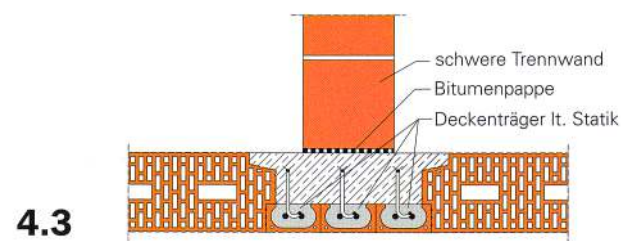
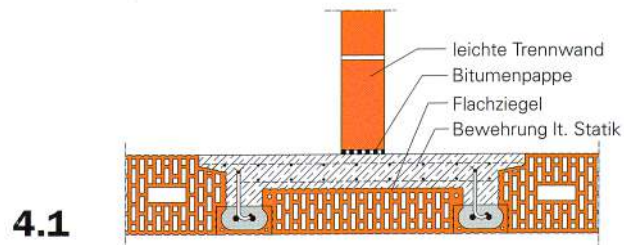



5 Unterzug

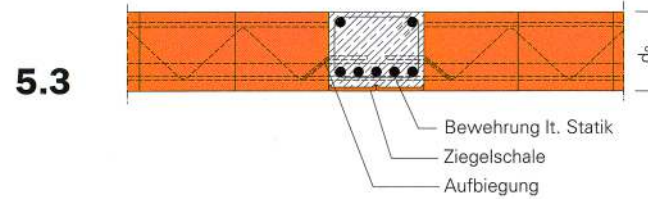
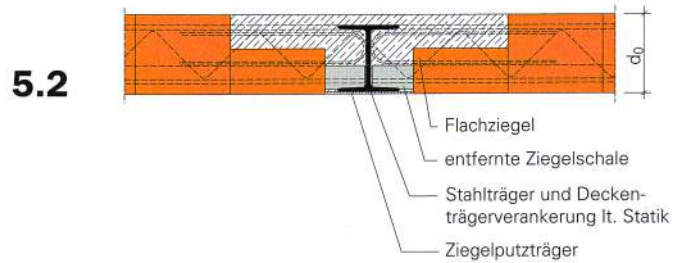

6 Balkone, thermisch getrennt

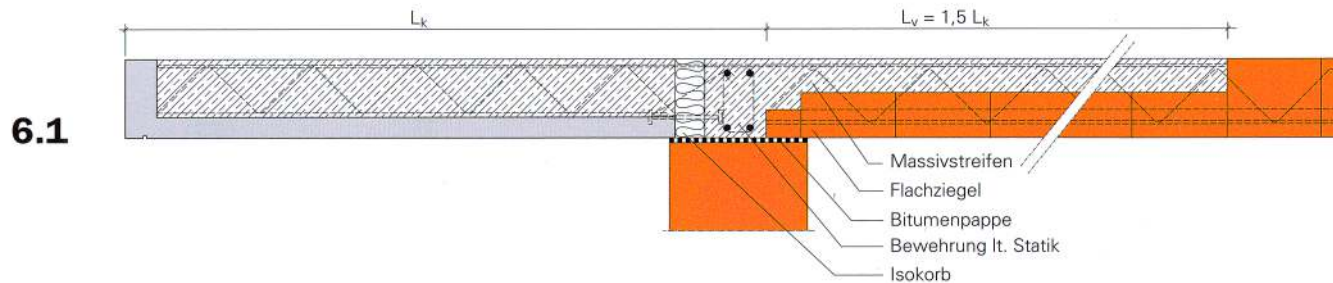

7 Treppenabfangung

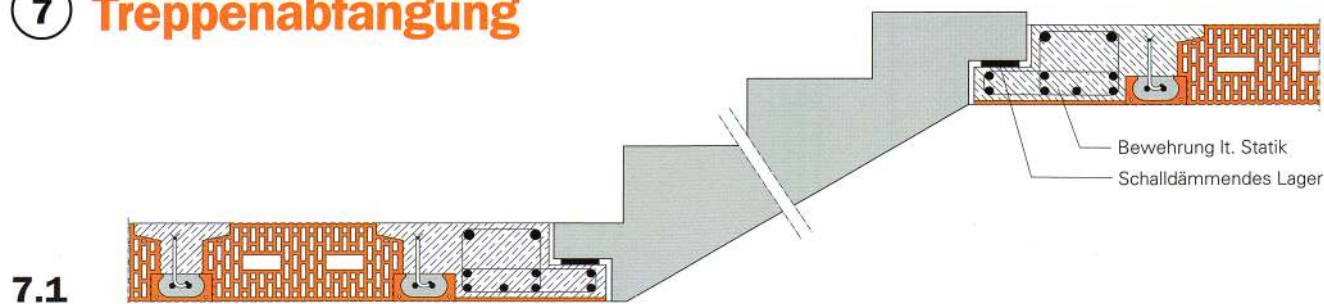

Befestigung untergehängter Decken

... mit integriertem Abhängesystem

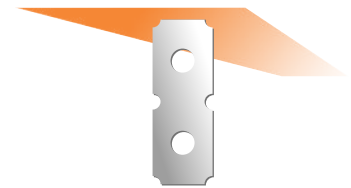

... mit Injektionsanker

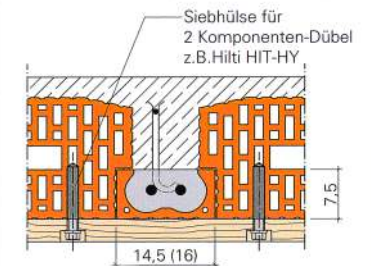

... mit Bügel

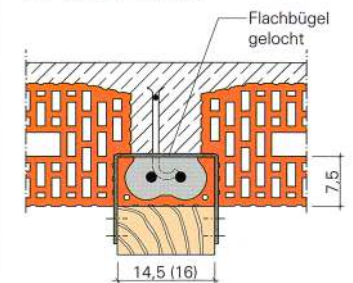



7.3

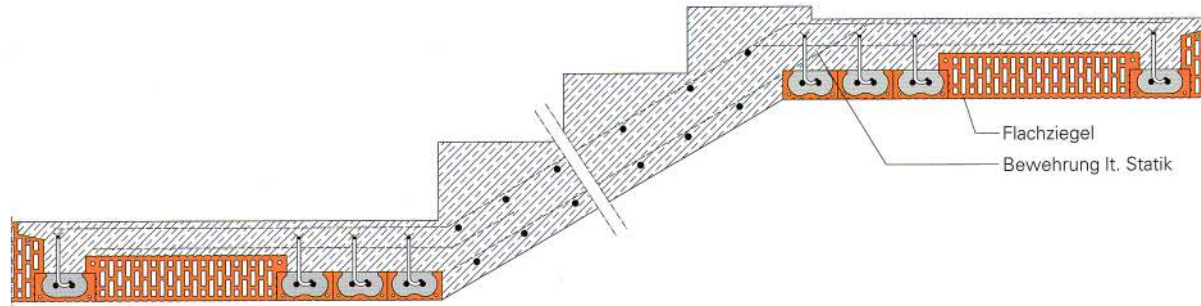

8 Dachrandausbildung

8.1

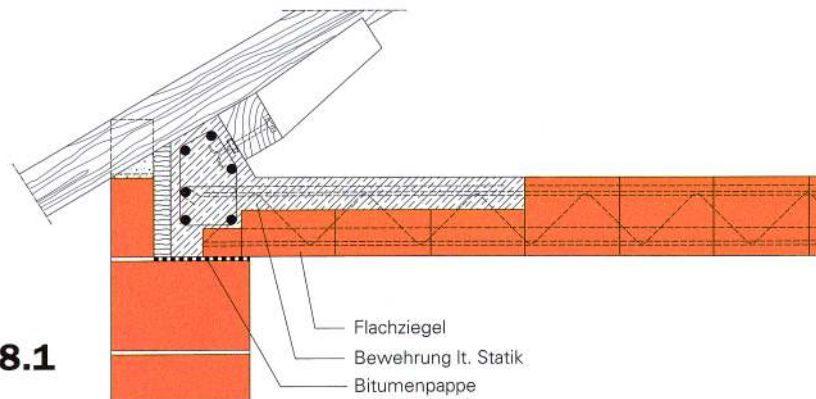

8.3

